

ozlux[®]

ENERGY SAVING
LAMPS

T5 MIRROR OPTIC LUMINAIRE

Ozlux[®] Light Fixture Series



T5 Mirror Optic Luminaire featuring Ozlux® Lamp Technology

Electrical and Technical Data

Product Number	Watts	Power Factor	Bulb	Base	Pkg. Qty.	Optics	CRI	Dimension LxWxH (mm)	Rated Avg. Life (Hrs) ¹	Approx. Initial Lumens ²
OZFR22X2	2x14	>0.95	T5	G5	2	Polycarbonate	85	589 x 298 x 50	20,000	2700
OZFR23X2	3x14	>0.95	T5	G5	2	Polycarbonate	85	598 x 598 x 50	20,000	4050
OZFR42X2	2x28	>0.95	T5	G5	2	Polycarbonate	85	1198 x 298 x 50	20,000	5800
OZFR43X2	3x28	>0.95	T5	G5	2	Polycarbonate	85	1198 x 598 x 50	20,000	8700

1) Average life under specified test conditions with lamps turned off and restarted no more frequently than once every 3 operating hours. Lamp life is appreciably longer if lamps are started less frequently.

2) Approximate initial lumens. The lamp lumen output is based upon lamp performance after 100 hours of operating life, when the output is measured during operation on a reference ballast under standard laboratory conditions.

Comparison of Polar Curve

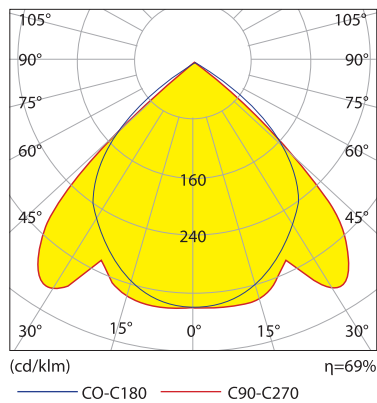

Dimensions (mm)

OCFR22X2 / OCFR42X2

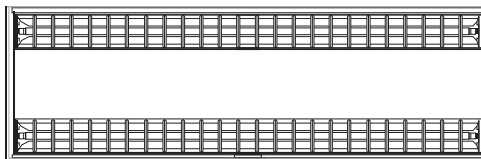

298 (W)

Celling cutout size (mm):
2 x 14W | 580 (L) x 280 (W)
2 x 28W | 1180 (L) x 280 (W)

OCFR23X2 / OCFR43X2

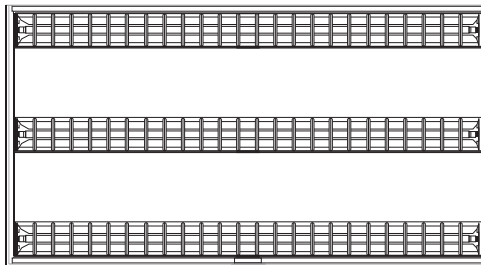

598 (W)

Celling cutout size (mm):
3 x 14W | 580 (L) x 580 (W)
3 x 28W | 1180 (L) x 580 (W)

596 / 1198 (L)

Installation Guide

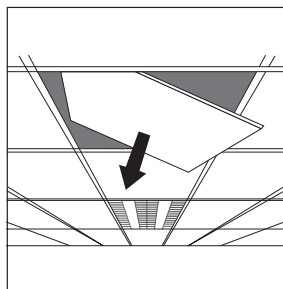

1. Remove the false ceiling tile.

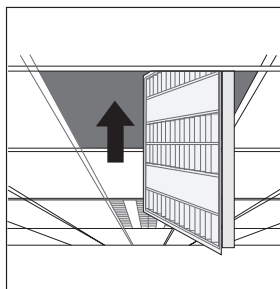

2. Insert the T5 Mirror Optic Luminaire vertically.

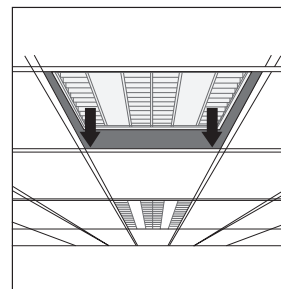

3. Once it's fully inserted, turn it horizontally & place it on the ceiling. Make sure the reflector is facing downward.

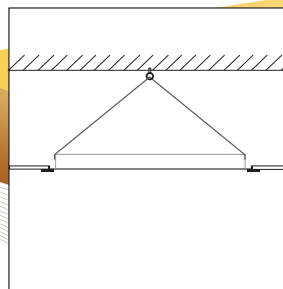

4. Secure the safety cable.

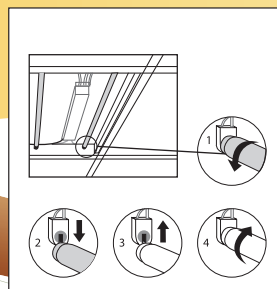

5. Check the ballast connection and tube fitting are in good condition before switching on.